



Batten GEOTEC®A

FIRE RESISTANT ACCESSORIES



Ventilation



Smoke extraction



Fire protection
services



Fire-protection up
to 2 hours



100% natural and
silicate-free plaster-
based product

EI 30 - 60 (S) / EI 90 - 120 (S)
30 to 120 minutes fire-resistant

FIRE-RESISTANT ACCESSORIES

The batten is a pre-moulded fire stop accessory of 45 x 45 mm made of plaster and fibreglass. This element facilitates the screwing of the panels together when the GEOTEC® ducts or the fire protections services are attached to the wall or slab.

Advantages

- ✓ Silicate-free product, which does not generate silica dust during cutting
- ✓ Possible application of water-based acrylic paint
- ✓ Cutting with a circular saw, sabre saw or handsaw
- ✓ Possible application of a water-repellent treatment that does not modify the fire resistance performance
- ✓ Meets environmental, health and safety standards

Installations



GEOLCOL® glue +
screws

Applications

- The batten is to be placed in the inner corners of the ducts or recesses in order to be able to screw the plates together.

Batten used in a horizontal duct when abutting the slab

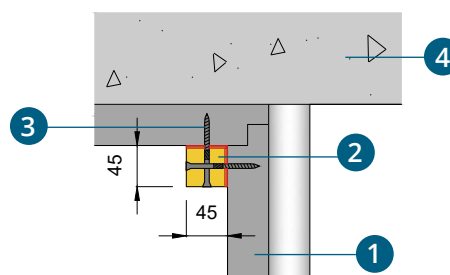

Batten used in a vertical duct when abutting the wall

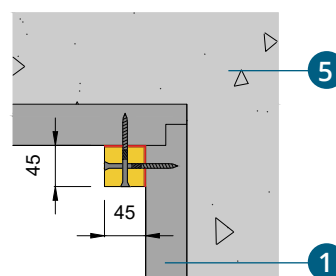

- 1 GEOTEC® duct
- 2 GEOTEC®A batten
- 3 Woodscrew VBA Ø 5
- 4 Concrete slab
- 5 Concrete wall

Dimensions

Thickness (mm)	EI (mm)	Length (m)	Width (mm)
45	30 to 120	1	45

*E = Flame and hot gas tightness
I = Thermal insulation*

The data in this table are average values, given for information only. If certain properties are essential for some particular application, we should preferably be consulted.

Transport and storage

Transport and store on a flat, protected surface (out of water).

Classification and tests

✓ Certified according to the fire resistance test standards:

EN 1366-1

EN 1366-5

EN 1366-8

✓ Certified according to the fire resistance classification standards:

EN 13501-2

EN 13501-3

EN 13501-4

Technical documents available

- ☒ Technical data sheet
- ☒ Environmental and health declaration form being renewed

Items codes

Reference	Water repellent	Name	Packaging	Gross weight / pallet
ACF0005	ACFH005	Batten 45 x 45 mm - 1,00 m	400 Units/Pallet	685 kg

 GEOTEC® range

Geostaff has collected the data in this sheet with all due care and reserves the right to modify the properties of the products without prior notice. The user of these data will be responsible at all times for their correct application. In case of uncertainty or doubt, we advise you to contact Geostaff in order to verify if these data correspond to the required application.

Batten
GEOTEC® A

FIRE RESISTANT ACCESSORIES



www.geostaff.fr/en